

**BUILDING PLAN ASSESSMENT**

Clear of Hunter Water Assets

Reference No: 124413

☒ Water not available for connection

☒ Sewer not available for connection

Only valid for 124413

Development Assessment (Section 50) application has been submitted and is being reviewed by Hunter Water. A Hydraulic Design Assessment application is required if development is larger than 2 units or commercial/industrial.

Only valid for 124413

Only valid for 124413

Date Processed: 24 June 2024

Applicant: Perception Planning - Renee Neely

Property Location: 256 LENNOXTON RD VACY NSW 2421

PLEASE TAKE INTO CONSIDERATION

This is not a compliance certificate. This stamp indicates that Hunter Water has undertaken an initial assessment of the proposed development to identify possible impacts to our infrastructure. Conditions of Hunter Water easements apply. For information on Hunter Water's processes please refer to our 'Land Development Manual' on our website or contact us on 1300 657 657. Version 3.3 (22 December 2021)

LEGEND

PROPOSED BOUNDARY LINE

ADJACENT BOUNDARY

REV.	DATE	AMENDMENT(S)	SUR	DFT	CHK
A	22.04.20	ISSUED FOR COMMENT	--	TC	TC
B	9.02.22	ISSUED FOR COMMENT	--	TC	TC
C	2.02.24	CONVERTED TO MGA2020, PATERSON RIVER BOUNDARY AMENDED	--	TC	TC

DELFS LASCELLES

CONSULTING SURVEYORS

260 MAITLAND ROAD,
MAYFIELD NSW 2304
ABN: 28 164 260 100

T: (02) 4964 4886
E: admin@delacs.com.au
delacs.com.au

**PROPOSED SUBDIVISION OF LOT 8
DP739338 AND LOT 94 DP788016**

SITE ADDRESS:
256 LENNOXTON ROAD
VACY

CLIENT:
PETER EVANS

CAD REF: 20186_Site Plan_Rev C

POSITION DATUM:
ORIENTATION:
EASTING:
NORTHING:
CLASS: --
HEIGHT DATUM:
CLASS: --
RL: (AHD)

CORSNET
MGA (GROUND)
--
--
ORDER: --
CORSNET
ORDER: --
DATE: --

SURVEYED	DRAFTED	CHECKED
--	TC	TC
SCALE	PAGE SIZE	DATE
1:2500	A1	22.04.20
SHEET	REV.	PROJECT No.
1 of 2	C	20186



HUNTER WATER CORPORATION

A.B.N. 46 228 513 446

ArcGIS Web Map

Enquiries: 1300 657 657

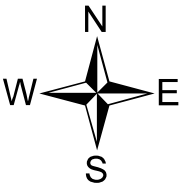

RATEABLE PREMISE NO.: 8327713464

LOT/SECTION/DP: 8//739338

PROPERTY ADDRESS: 256 LENNOXTON RD VACY, 2421

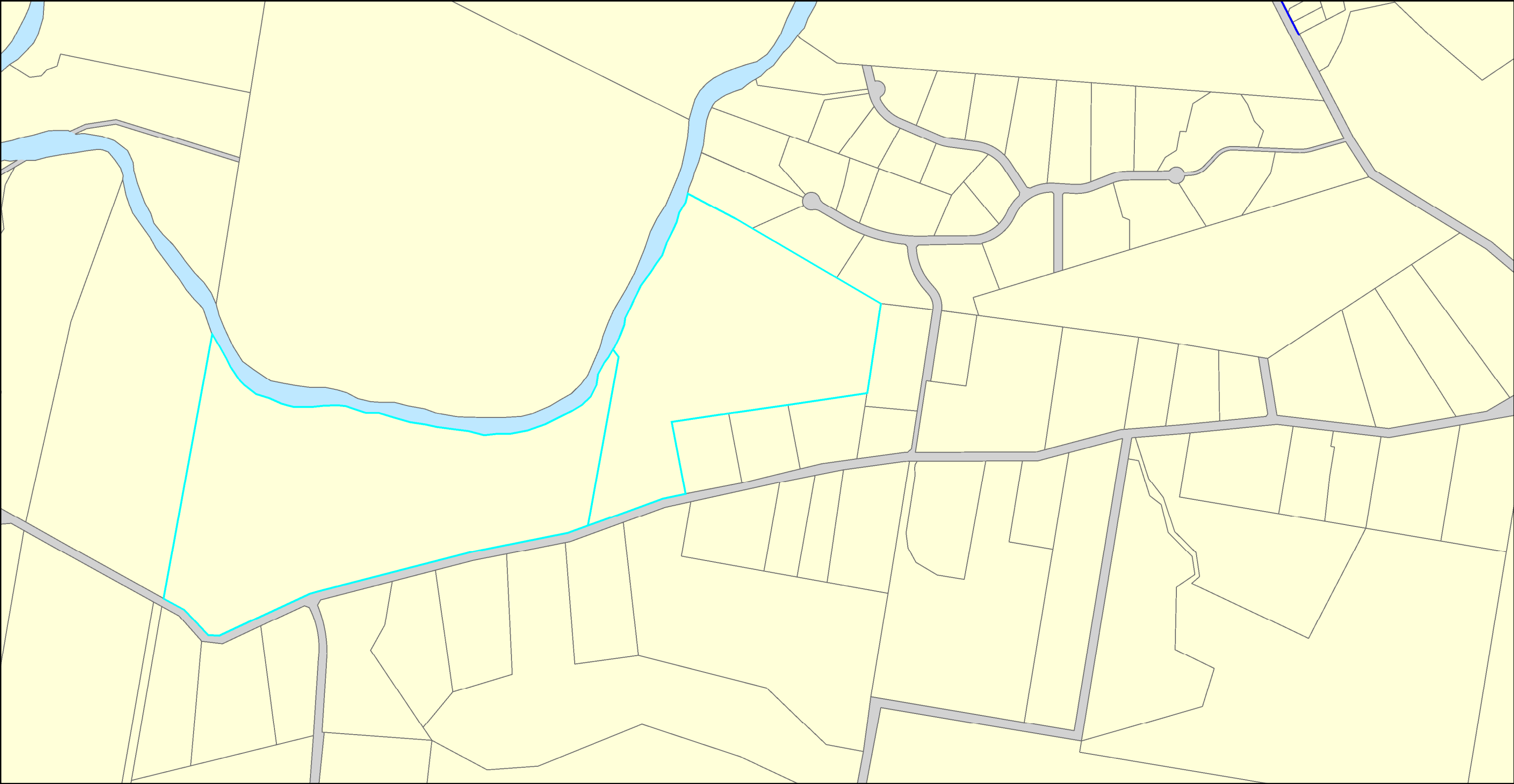

Date: 24/06/2024

Scale: at A3 1:10,000

CADASTRAL DATA © Department Finance,
Services & Innovation [Nov 2017].
Modified [24/06/2024] AERIAL DATA © NearMap
CONTOUR DATA © AAMHatch
© Department of Planning

SEWER/WATER/RECYCLED WATER/ELECTRICAL
UTILITY DATA
© HUNTER WATER CORPORATION

HUNTER WATER ASSETS POSITION ARE
APPROXIMATE ONLY.
SUBJECT PROPERTY BOLDED.
ALL MEASUREMENTS ARE METRIC.

IMPORTANT:
ANY INFORMATION ON THIS PLAN MAY NOT BE UP TO DATE AND THE CORPORATION ACCEPTS NO RESPONSIBILITY
FOR ITS ACCURACY.